

Portable Thermal Printer With Auto-Cutter

(3 inch/80mm)



Attentions:

- The printer should be away from the water and avoid the sunlight, glare and heat source direct exposure. Avoid any liquid, dust and metal objects into the interior of the printer.
- The high environment temperature (>45°C) or the low temperature(<5°C) will reduce the print quality.
- The high humidity (>85%RH) or the low humidity (<20%RH) will reduce the print quality.
- Don't open the cover of paper bin in printing process.
- Using low quality or storage too long time print paper will reduce the print quality, even damage the printer.
- If there is dirt at the print head, need to use a soft cotton or cotton swab to dip alcohol and wipe it clean to prevent the print head from being worn.
- Don't touch the print head and retainer directly in order to avoid damaging the print head because of static electricity. Don't scratch or touch the print head with a hardened object to avoid damaging the print head.
- Please try to use up the battery before charging, which can effectively protect the battery life.
- Please using the power supply attached to the product, or else, it maybe damage the printer or cause the charging time to extend.
- In the course of any accident, please disconnect the printer power supply, and remove the printer battery immediately.
- If user disassemble the printer, the company has the right to refuse warranty on the product.

▲ This printer uses a thermal resistance to detect the temperature of the print head. If the print head is overheated, the circuit will cut off the power and stop printing. The overheat temperature of the print head is 80°C.

Storage precautions:

- If not to use the printer for a long time, please be sure to remove the battery from printer, and disconnect the charger's power supply.
- The storage time of printing content is short using the ordinary thermal printing paper. If you want to print the long-term preservation, please select the long-term thermal printing paper.
- The thermal printing paper should not be stored in high temperature, humidity environment, or direct sunlight. If its package has been opened, please place it in the dark place.

1. Product introduction

Thank you for purchasing our products. This product is a thermal receipt printer with auto-cutter. It's very easy to use and maintain for easy paper loading. Support USB port, bluetooth and other wireless communication to connect to other devices, such as computers, Android or iOS mobile Terminal devices. It can be widely used in the fields that real-time receipt printing is needed.

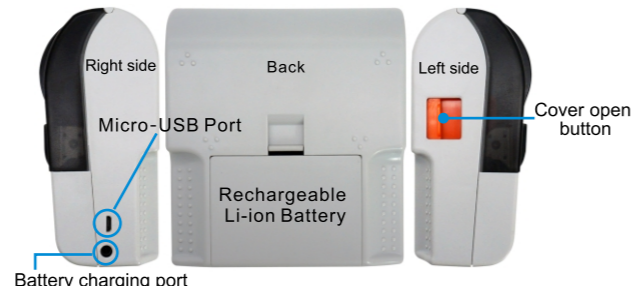
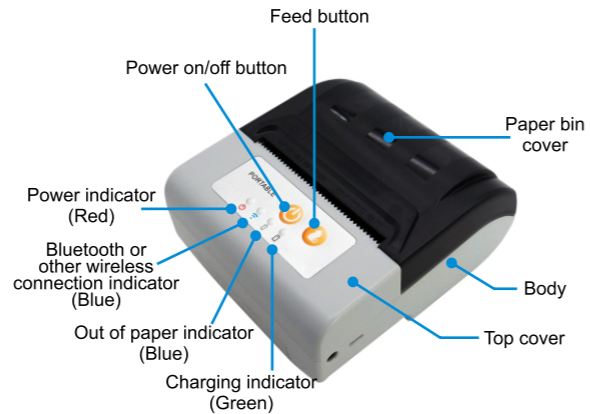

2. Functions and features

Items	Parameters	
Printing parameters	Printing method	Thermal dot line printing
	Resolution	203DPI, 8dots/mm
	Printing width	72mm (576 dots)
	Printing speed	100mm/s
Communication	Wired	Standard: Micro-USB port
	Wireless	Optional: 2.0 Bluetooth/SPP(for Andriod), 4.0 Bluetooth/BLE(for iOS)
Command sets	/	ESC/POS Command sets
Storage	RAM	16KB for receive buffer
	FLASH	FLASH: 4MB, NV BMP FLASH: 64KB
Characters	Chinese	GB18030 24×24
	Characters and figures	ASCII 9×17,12×24
	User defined Language(code page)	Support Support simplified & traditional Chinese, English and other 45 kinds of international character sets.
Tables	/	Support dots printing with different densities
	/	Support raster bitmap print
Barcode	1D	UPC-A, UPC-E, EAN-8, EAN13, CODE39, ITF, CODEBAR, CODE128, CODE93, etc.
	2D	QR Code
Detection	Sensor	Out of paper
Indicators	LED	Power(red), Battery charging(Green), Bluetooth and Out of paper(Blue)
Printing Paper	Type	Standard thermal receipt paper
	Width	79.5±0.5mm
	Thickness	0.056~0.1mm
	External diameter	50mm(Max)
	Paper loading	Easy paper loading structure
Physical features	Paper tore	Manual or Auto cutting
	Operating environment	Temperature: -10°C ~ 50°C, Humidity: 25% ~ 80%RH
	Storage environment	Temperature: -40°C ~ 70°C, Humidity: ≤93%RH(40°C)
	Size	121.1mm×109.3mm×57.6mm(L×W×H)
Reliability	Weight	350g (Printer & Battery)
	Print head	150Km
Softwares	Cutter	360,000 hours
	Drivers	Windows (WIN7/WIN8/VIN10/Vista/XP/2000)
Power Supply	App	Printer setting tools
	Battery	Rechargeable Li-ion Battery, 7.4V, 2000mAh
Charger	Input: 100-240VAC/0.2A,50/60Hz; Output: 12VDC/1A	

3. Basic operation

3.1 Power on the printer

In power off status, press down the "Power on/off" button and hold on 2 seconds, then the printer will beeps once and into working status, the power indicator light (red).

Noted: If the "charging indicator (green)" of printer flashing, indicating that the battery power of the printer has been less than 20%, please charge it in time.

3.2 Power off the printer

In power on status, press down the "Power on/off" button and hold on 2 seconds, the printer will beeps twice then power off, and all the indicators will go out.

3.3 Print self-test page

After the user gets the printer, the printer can be self-test to detect the current settings and working status.

When the printer is power off and the print paper is loaded correctly, press down the "Power on/off" button and "Feed" button simultaneously, after hearing a beep sound, release the two buttons, the printer will print a self-test page.

The self-test page contains information about the current status of the printer, settings and printing examples, such as the battery power, Bluetooth PIN, Bluetooth BDA, printing language, program version, font, etc.

3.4 Feed paper(manual)

In the normal working status, press the "Feed" button, the printer will feed paper.

3.5 Battery charging

After using a period of time, the printer's battery power will be consumed, when the printer's green indicator light flashing slowly, indicating that the battery power has less than 20% and need to charge in time. This printer uses a charger for battery charging which output 12VDC/1A. Full charge takes about 4 hours.

The battery charging method:

Insert the AC input plug of the charger into the AC power socket(100-240VAC, 50/60Hz) and insert the output plug into the power input socket of the printer(12VDC/1A). When charging, the green indicator will flash. When the battery power is sufficient or the battery is fully charged, the green indicator light goes out.

3.6 Paper loading method

Open the cover of paper bin, draw out the head of paper roll, and put it into the paper bin in the direction shown below.



4. Communication connection

4.1 By Bluetooth

This series of printers can be equipped with Bluetooth 2.0 (SPP) or Bluetooth 4.0 (BLE) communication function. Bluetooth 2.0 can support the communication with the mobile terminal based on the Android system, and Bluetooth 4.0 can support the communication with the mobile terminal based on the Apple iOS system.

Bluetooth connection method: After power on the printer, use the mobile terminal or the other communication equipment with Bluetooth to search the printer, after selecting the corresponding printer, enter the Bluetooth PIN code to connect, after successful connection, can be used normally. Usually Bluetooth PIN code is "0000", for more details, please refer to the "self-test page".

4.2 By USB port

Before using the USB port to printing communication, you need to use the USB cable to connect the printer and PC.

The USB port can be set to "virtual serial port" or "print port" modes. Usually, the "print port" mode doesn't need to install the driver, but the "virtual serial port" mode need it.

The USB port working mode switching method: (1) Power off the printer and load paper correctly → (2) Press down the "Power on/off" button and "Feed" button simultaneously, loosen them until the printer finished "self-test page" printing → (3) Press down the "Feed" button for 2 seconds again to complete the switch operation (at the bottom of the "self-test page" will have a corresponding description).

5. Accessories

- Printer 1PC
- Battery 1PC
- Charger 1PC
- USB cable 1PC
- Paper roll 1PC
- User's manual 1PC

※ Note: the specific product accessories may be different from this list, if in doubt, please consult your supplier.

Appendix: The instructions of indicate light and buzzer signal

The printer is provided with a buzzer and 4 indicating lights for prompting the printer status, the indicator lights are used to indicate the current state of the printer, and the buzzer is used to indicate the change of the printer status.

The details are as follows:

Indicator light	Indicator status	Printer status
Power indicator (Red)	ON	Power on status
	OFF	Power off status
	Flash	Standby status
Bluetooth indicator (Blue)	OFF	Bluetooth disconnected
	ON	Bluetooth connected
Out of paper indicator (Blue)	ON	Out of paper
	OFF	Enough paper
Battery charging indicator (Green)	Flash (Power on status)	Charging
	ON (Power off status)	Charging
	OFF	Battery power is full

Operation	Printer's action	Buzzer's action
Long press "Power on/off" button in the power off status	Power on	Beep 1 sound
Long press "Power on/off" button in the power on status	Power off	Beep 2 sound
Press "Feed" button in the power on status	Feeding paper	Beep 1 sound

※ Note: If the standby time of the printer is set to 0 second, then the printer will immediately into the standby state after POST, and the power indicator light will still flashing.

Contents of this manual without the permission of the company shall not be free to change and replication, we reserve the right to change the product, if user needs the product further information can contact directly with the supplier.